

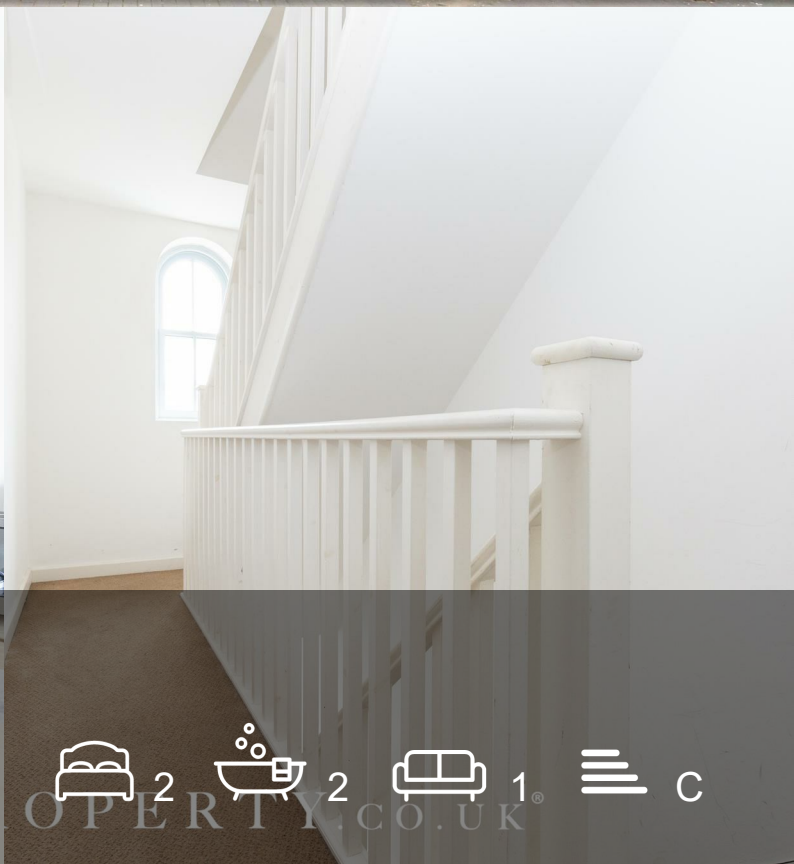

Flat 1 22 Augusta Street

Birmingham, B18 6JA

£800 PCM



2 2 1 C

Floor Plan



Area Map

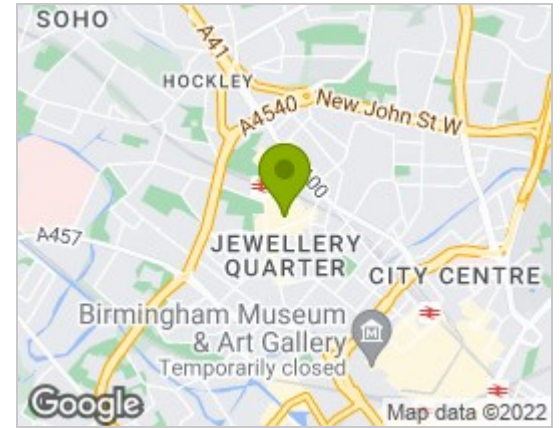

Energy Efficiency Graph

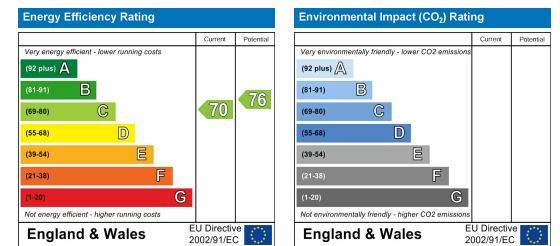

Viewing

Please contact our LV PROPERTY Office on 01212857575 if you wish to arrange a viewing appointment for this property or require further information.

- LUXURIOUS TWO BED APARTMENT
- FURNISHED TO A HIGH STANDARD
- WALKING DISTANCE TO ALL AMENITIES
- SITUATED IN THE PRESTIGIOUS JEWELLERY QUARTER
- OPEN PLAN KITCHEN & LIVING AREA
- PARKING AVAILABLE (VIA PERMITS)



LV PROPERTY proudly presents this newly built two bedroom three-storey apartment in the sought after area of the Jewellery Quarter, just a short walk from Birmingham City Centre. This beautiful and extremely spacious apartment comprises a spacious bedroom with an en-suite shower room. Carpeted stairs leading to an open plan lounge/kitchen/diner with integrated oven, hob and extractor fan. Further stairs lead to the upper floor bedroom and en-suite bathroom. Further benefits include neutral décor and laminate flooring to living areas. The original feature characteristic building windows give a bright and airy ambience. The property also benefits from CCTV secure entry and is near to transport links (bus, train, metro). This is a unique opportunity to live in a truly exceptional converted characteristic building.



These particulars, whilst believed to be accurate are set out as a general outline only for guidance and do not constitute any part of an offer or contract. Intending purchasers should not rely on them as statements of representation of fact, but must satisfy themselves by inspection or otherwise as to their accuracy. No person in this firm's employment has the authority to make or give any representation or warranty in respect of the property.



0121 285 7575
www.lvproperty.co.uk

157c Warstone Lane, Jewellery Quarter,
Birmingham, West Midlands, B18 6NZ